

TYPICAL (1ST, 2ND, 3RD, 4TH, 5TH, 6TH & 7TH) FLOOR PLAN

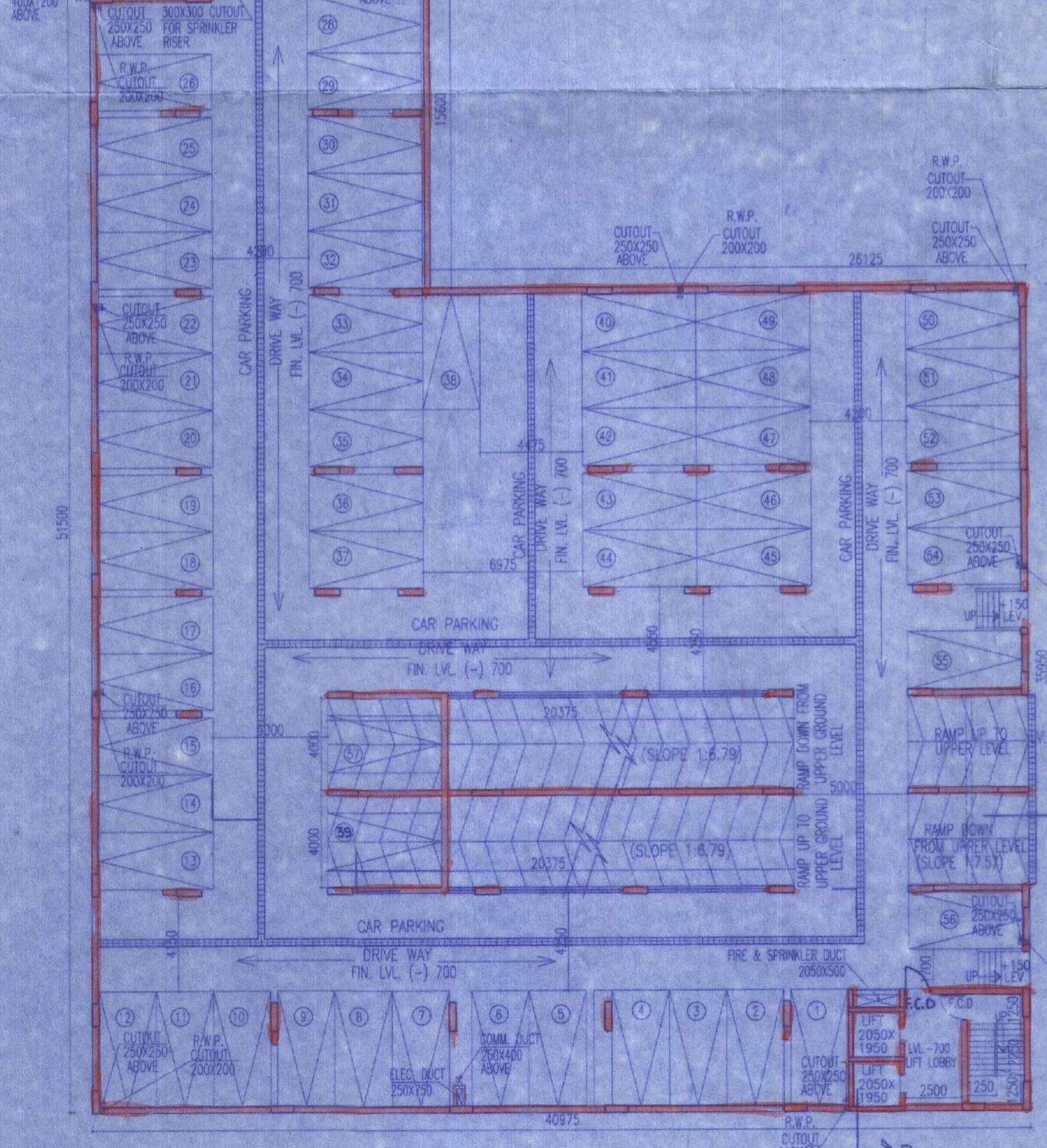

LOWER GROUND FLOOR PLAN

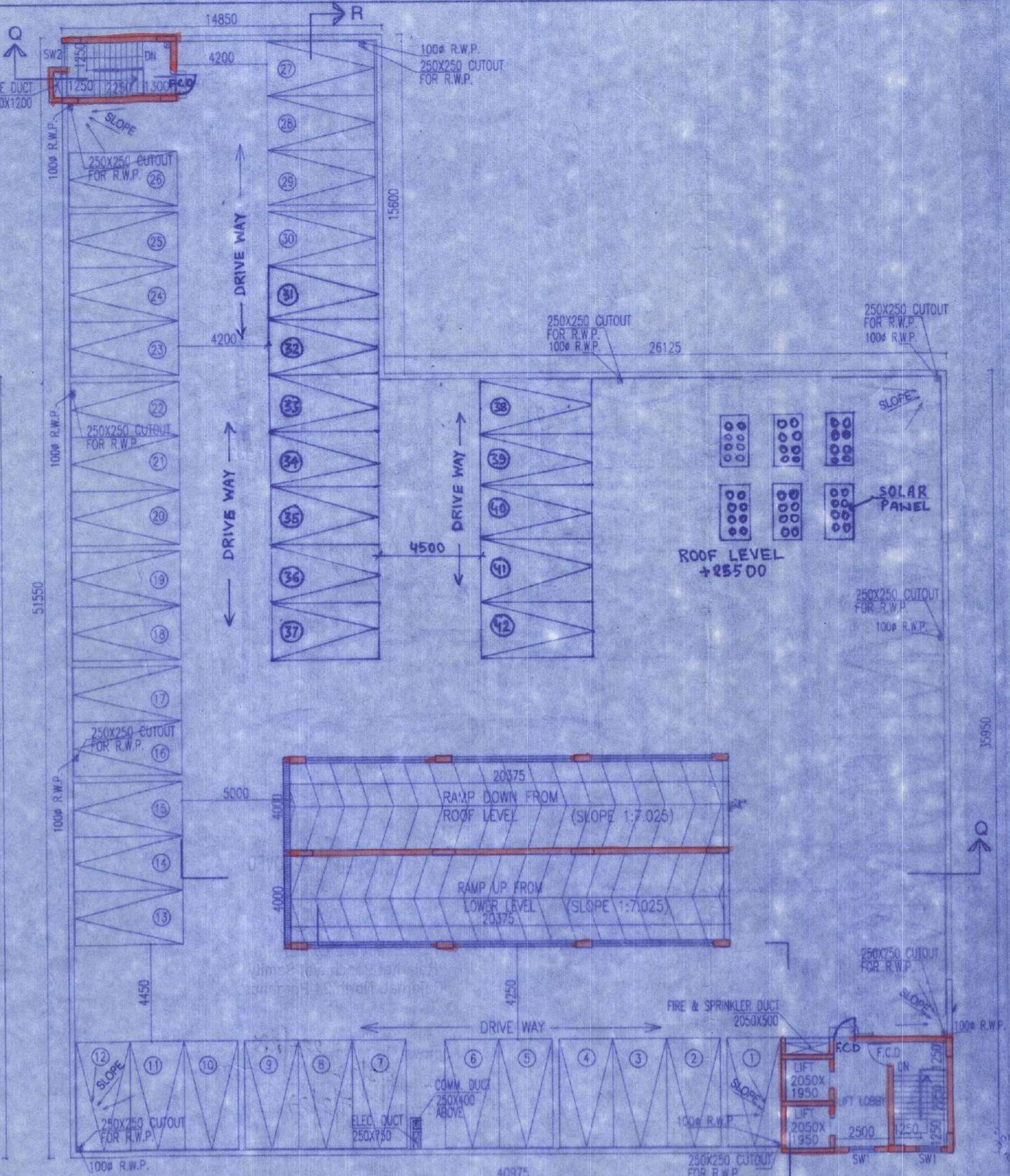

ROOF PLAN

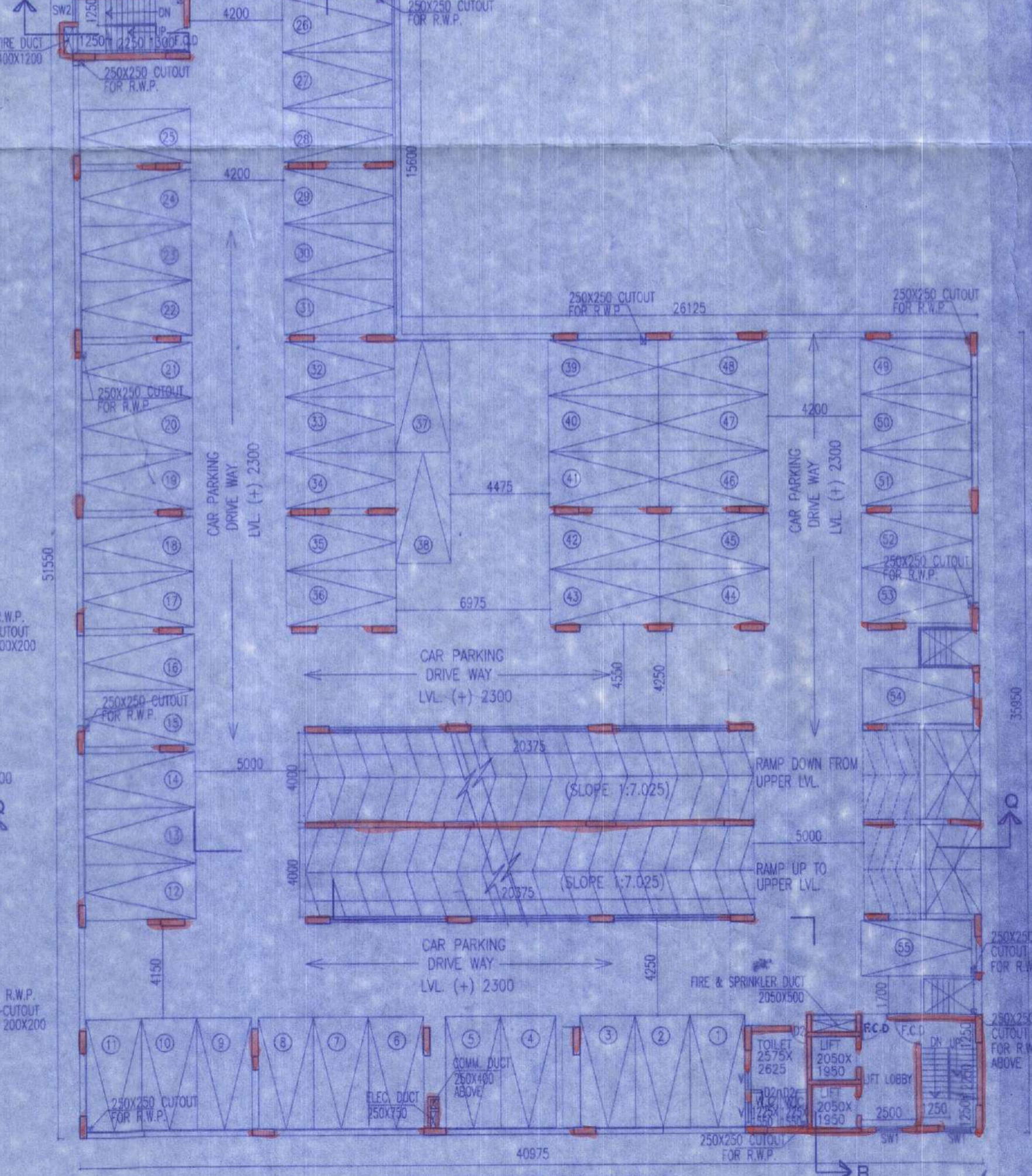

UPPER GROUND FLOOR PLAN

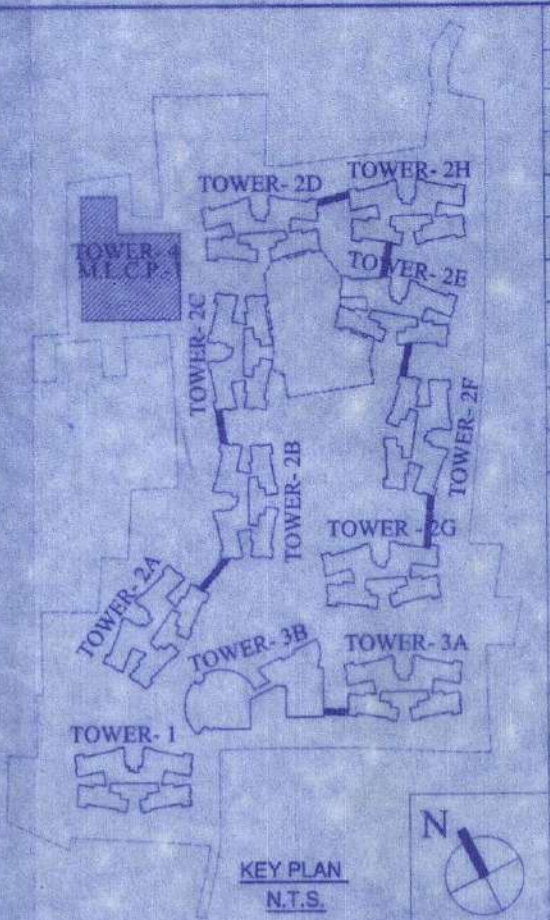

KEY PLAN N.T.S.

NAME OF OWNER  
NAME OF THE COMPANY

1. M/s. Alishan Supply Private Limited
2. M/s. Adva Real Estates Private Limited
3. M/s. Anchor Vanija Private Limited
4. M/s. Anratma Advisory Private Limited
5. M/s. Anratma Dealers Private Limited
6. M/s. Anukaran Supply Private Limited
7. M/s. Aravali Hirise Private Limited
8. M/s. Arch Vanija Private Limited
9. M/s. Arpana Consultancy Private Limited
10. M/s. Arpana Tie Up Private Limited
11. M/s. Artline Homes Private Limited
12. M/s. Artline Projects Private Limited
13. M/s. Artline Realstate Private Limited
14. M/s. Average Complex Private Limited
15. M/s. Average Housing Private Limited
16. M/s. Average Infracon Private Limited
17. M/s. Average Nirman Private Limited
18. M/s. Average Projects Private Limited
19. M/s. Basudev Enclave Private Limited
20. M/s. Basudev Housing Private Limited
21. M/s. Bluebird Tie Up Private Limited
22. M/s. Booster Hirise Private Limited
23. M/s. Booster Hirise Private Limited
24. M/s. Brijbhumi Vapaaar Private Limited
25. M/s. Brijbhumi Tie Up Private Limited
26. M/s. Citywings Vapaaar Private Limited
27. M/s. Crossway Heights Private Limited
28. M/s. Crossway Nirman Private Limited
29. M/s. Dayanidhi Suppliers Private Limited
30. M/s. Delta Vapaaar Private Limited
31. M/s. Dhanganga Hirise Private Limited
32. M/s. Dhanganga Infracon Private Limited
33. M/s. Dhanganga Realty Private Limited
34. M/s. Dhanganga Residency Private Limited
35. M/s. Dreamland Hirise Private Limited
36. M/s. Elegant Nirman Private Limited
37. M/s. Gajaganini Vinimay Private Limited
38. M/s. Gajaganini Buldcon Private Limited
39. M/s. Gajaganini Constructions Private Limited
40. M/s. Gajaganini Hirise Private Limited
41. M/s. Gajaganini Realty Private Limited
42. M/s. Gajmukhi Enclave Private Limited
43. M/s. Gajmukhi Homes Private Limited
44. M/s. Gajmukhi Infracon Private Limited
45. M/s. Gajmukhi Nirman Private Limited
46. M/s. Gajmukhi Projects Private Limited
47. M/s. Gajmukhi Realstate Private Limited
48. M/s. Ganesh Tracom Private Limited
49. M/s. Ganeshvani Promoters Private Limited
50. M/s. Greentop Nirman Private Limited
51. M/s. Guidance Vapaaar Private Limited
52. M/s. Gullmarg Vapaaar Private Limited
53. M/s. Hanurang Tie Up Private Limited
54. M/s. Indivar Tracom Private Limited
55. M/s. Jainendra Distributors Private Limited
56. M/s. Jainendra Marketing Private Limited
57. M/s. Jainendra Merchants Private Limited
58. M/s. Jaldham Advisory Private Limited
59. M/s. Jaldham Tie Up Private Limited
60. M/s. Jhilmil Sales Private Limited
61. M/s. Jhilmil Vapaaar Private Limited
62. M/s. Jinay Merchants Private Limited
63. M/s. Juhi Marketing Private Limited
64. M/s. Kalakriti Enclave Private Limited
65. M/s. Kalakriti Homes Private Limited
66. M/s. Kalakriti Housing Private Limited
67. M/s. Kalakriti Properties Private Limited
68. M/s. Kalakriti Realty Private Limited
69. M/s. Karmyabi Consultants Private Limited
70. M/s. Lifelong Enclave Private Limited
71. M/s. Limelight Hirise Private Limited
72. M/s. Linkrose Constructions Private Limited
73. M/s. Linkrose Housing Private Limited
74. M/s. Linkrose Residency Private Limited
75. M/s. Manobal Dealer Private Limited
76. M/s. Manobal Vanija Private Limited
77. M/s. Matrix Sales Private Limited
78. M/s. Maxflow Barter Private Limited
79. M/s. Moonlife Constructions Private Limited
80. M/s. Moonlife Nirman Private Limited
81. M/s. Moonlife Residency Private Limited
82. M/s. Mridul Advisory Private Limited
83. M/s. Newwave Merchants Private Limited
84. M/s. Original Realty Private Limited
85. M/s. Panghat Supply Private Limited
86. M/s. Pawarputra Barter Private Limited
87. M/s. Pawarputra Sales Private Limited
88. M/s. Prabhakar Barter Private Limited
89. M/s. Prajapati Commercial Private Limited
90. M/s. Prajapati Dealer Private Limited

SCHEDULE OF DOORS & WINDOWS (M.L.P)			
NO.	SILL	LINTEL	SIZE
F.C.D	-	2150	1125 X 2150
D	-	2150	1200 X 2150
D4	-	2150	1000 X 2150
D4A	150	2300	1000 X 2150
D4B	250	2300	1000 X 2050
D4C	350	2150	1200 X 1800
SW1	350	2150	1100 X 1800
D2	-	2150	750 X 2150
V	AS PER DETAIL		

CERTIFICATE OF STRUCTURAL ENGINEER  
CERTIFY THAT THE STRUCTURAL DRAWING AND DESIGN OF BOTH THE FOUNDATION AND SUPERSTRUCTURE OF THE BUILDING / BUILDINGS HAS BEEN MADE CONSIDERING THE SOIL TEST REPORT, AS PER THE RULES AND REGULATIONS MADE UNDER THE ACT AND ALSO CONSIDERING ALL POSSIBLE LOADS, SEISMIC LOADS AND THE MOMENTS GENERATED BY THE PROPOSED STRUCTURE AS PER THE BUREAU OF INDIAN STANDARD AND NATIONAL BUILDING CODE OF INDIA AND CERTIFIED THAT IT IS SAFE AND STABLE IN ALL RESPECT AND THESE PROVISIONS SHALL BE ADHERED TO DURING THE CONSTRUCTION.

**SANJIV PAREKH**  
M.E. (STRUCT.), M.E. (CONST. ENG.),  
H. C. E., F.I.E. (F-418202-4)  
STRV/NKDA/10/00030

SIGNATURE OF STRUCTURAL ENGG.  
NAME: Sanjiv Parekh  
ENROLLMENT NO. STRV/NKDA/10/00030

CERTIFICATE OF ARCHITECT  
I CERTIFY THAT ALL THE ARCHITECTURAL DRAWINGS OF THE PROJECT AT R.S. DAG NOS. 470(P), 471(P), 473, 474, 475, 476, 477, 478, 479, 480, 481, 482, 483, 484, 485, 486, 487, 489, 500, 501(P), 502(P), 503, 504(P), 506(P), 507(P), 509(P), 528(P), 529(P), 530(P), 531, 532, 533 & 501/716(P), OF MOUZA - BHATENDA, J.L. NO. 28 HAVE BEEN PREPARED BY ME COMPLYING WITH THE NEW TOWN KOLKATA PLANNING AREA (BUILDING) RULES, 2014. I ALSO CERTIFY THAT THE PLANS AND DRAWINGS PREPARED BY ME COMPLYING WITH ALL THE PROVISIONS REGARDING THE FIRE PROTECTION AS PER THE PREVAILING NATIONAL BUILDING CODE OF INDIA SHALL BE HELD RESPONSIBLE IF ANY INCOMPLETE INFORMATION IS FURNISHED BY ME OR ANY VIOLATION OF PROVISIONS OF THESE RULES OR THE PREVAILING NATIONAL BUILDING CODE IS FOUND IN ANY OF THE DRAWINGS AND DOCUMENTS, SIGNED BY ME AND SUBMITTED TO THE SANCTIONING AUTHORITY FOR OBTAINING SANCTION.

**MONAL AGRAWAL**  
Regd. Architect  
New Town Kolkata Development Authority  
Enrollment No. ACHR/NKDA/10/00020

SIGNATURE OF ARCHITECT  
NAME: MONAL AGRAWAL  
ENROLLMENT NO. ACHR/NKDA/10/00020

CERTIFICATE OF GEO - TECHNICAL ENGINEER  
IT IS CERTIFIED THAT THE COMPREHENSIVE GEO-TECHNICAL REPORT ON SOIL INVESTIGATION HAS BEEN PREPARED BY ME FOR DESIGN AND CALCULATION OF THE FOUNDATION BY ANALYZING THE SOIL SAMPLES FOR ESTIMATING THE BEARING CAPACITY OF THE SOIL ON WHICH FOUNDATION OF THE STRUCTURE WILL BE CONSTRUCTED. I SHALL ALSO CHECK THE NATURE OF THE SOIL AFTER EXCAVATION AT SITE SO THAT FOUNDATION IS EXTENDED UP TO THE APPROPRIATE DEPTH THAT HAS BEEN PROPOSED IN THE GEO-TECHNICAL REPORT.

**JISHNU PAL**  
B.Tech (Civil), M.E. (Geo-tech)  
KMC Reg No: G-T/1/132  
GTRR / NKDA / 10 / 0043  
22 / RJSON / G-T-1 / 2016 -17

SIGNATURE OF GEO - TECHNICAL ENGINEER  
NAME: Jishnu Kumar Mitra  
ENROLLMENT NO. GTRR-HIDCO-09/00010

*Subir Ranjan Sarkar*  
Authorised Signatory

**Subir Ranjan Sarkar**  
Regd. Town Planner  
New Town Kolkata Development Authority  
Enrollment No.: TPER/NKDA/10/00036

SIGNATURE OF TOWN PLANNER OR URBAN DESIGNER  
NAME: Subir Ranjan Sarkar  
ENROLLMENT NO. TPER/NKDA/10/00036

**SANJIB GUHA**  
BSC, BCE, F.I.E. (F-115654-5)  
CHARTERED ENGINEER  
STRV/NKDA/15/00003

SIGNATURE OF STRUCTURAL REVIEWER  
NAME: Sanjiv Guha  
ENROLLMENT NO. STRV/NKDA/15/00003

TITLE:  
LOWER GROUND FLOOR PLAN, UPPER GROUND FLOOR PLAN, TYPICAL (1ST, 2ND, 3RD, 4TH, 5TH, 6TH & 7TH) FLOOR PLAN & ROOF PLAN  
TOWER-4 (M.L.C.P.)

PROJECT:  
PROPOSED ADDITION OF 1NO. (G+1X) STORED RESIDENTIAL BUILDING NAMEDLY TOWER-2H & REVISION OF 1NO. (LG+UG+V7) STORED MI CP BUILDING NAMEDLY TOWER-4 WITH PREVIOUS SANCTIONED OF 1NO. (G+H) STORED BUILDING NAMEDLY 3B AND 3NC, (G+X 1X) STORED RESIDENTIAL BUILDING NAMEDLY TOWER-1, 2A, 2G, 3A, 2B, 2C, 2D, 2E & 2F APPROVED BY EXECUTIVE OFFICER, RAJAHAT PANCHAYAT SAMITI VIDE MEMO NO. 926/RPS DATED 28/08/2018.

IN WHICH OCCUPANCY CERTIFICATE HAS BEEN OBTAINED FOR 4NOS. TOWER NAMEDLY TOWER - 1, 2A, 2G & 3A VIDE MEMO NO. 266/RPS DATED 01.08.2019 FROM RAJAHAT PANCHAYAT SAMITI, IN RESIDENTIAL COMPLEX AT MOUZA - BHATENDA, J.L. NO. 28, R.S. L.B. DAG NOS. 470(PART), 471(PART), 473, 474, 475, 476, 477, 478, 479, 480, 481, 483, 489, 490, 491, 492, 493, 494, 495, 496, 497, 499, 500, 501(PART), 502(PART), 503, 504(PART), 506(PART), 507(PART), 509(PART), 526(PART), 528(PART), 529(PART), 530(PART), 531, 532, 533 & 501/716(PART), P.S. - RAJAHAT, WITHIN THE JURISDICTION OF RAJAHAT BISHNUPUR NO. 1 GRAM PANCHAYAT, DIST. - NORTH 24 PARGANAS.

ARCHITECTS		AGRAWAL & AGRAWAL	
BARODA	KOLKATA	SCALE	DATE
		1 : 200	05.03.2021
		SHEET NO.	DEALT
		9 OF 11	GARGI
		CHECKED	SHILA

SIGNATURE OF OWNER  
Alishan Supply Private Limited and Others  
111, Park Street, 1st Floor, Kolkata - 700 016

ARCHITECT:  
Monal Agorwal  
CIVIL STRUCTURAL ENGINEER:  
Sanjiv Parekh  
GEO-TECHNICAL ENGINEER:  
Jishnu Pal  
TOWN PLANNER/URBAN DESIGNER:  
Subir Ranjan Sarker  
STRUCTURAL REVIEWER:  
Sanjib Guha

Enrollment No: ACHR/NKDA/10/00020  
Enrollment No: BTER/NKDA/10/00030  
Enrollment No: GTER/NKDA/10/00093  
Enrollment No: TPER/NKDA/10/00036  
Enrollment No: STRV/NKDA/15/00003

STRUCTURAL DRAWINGS, STRUCTURAL  
DESIGN CALCULATIONS & SOIL TEST  
REPORT ARE NOT CHECKED AND KEPT  
FOR RECORDS ONLY.

Note: This NOC has been issued on the basis of  
documents submitted by the applicant and forwarded by the  
Addl. Executive Officer, North 24 Parganas Zilla Parishad.  
If there was error or misrepresentation or fact or fraudulent  
act or any act of suppression of fact in connection with the  
above project including the concerned land plans, drawings,  
design etc., then this NOC shall stand cancel.

NEW TOWN KOLKATA DEVELOPMENT AUTHORITY  
No Objection Certificate for  
Sanction of Building Plan for Construction Purpose  
Memo No. 481/NKDA-FPS-04(2)/2020  
Date: 24/01/22

Building Particulars Proposed addition of one (G+XIX) storied  
residential building (Tower-2H) and revision  
of NLCB Block at Mouza- Bhatenda, T.L.No. 28,  
North 24 Pgs.

Note: All the recommendations from Pollution Control Board is to be  
followed thoroughly at the time of construction.

Sayantani Majumdar  
Assistant Architect  
New Town Kolkata Development Authority

Tapan Kumar Dwari  
Chief Architect  
New Town Kolkata Development Authority

SANCTIONED & APPROVED

*Ra*  
Executive Officer  
Rajarhat Panchayat Samity  
Rajarhat, North 24 Parganas

Approval Order No. 287/RK  
Date: 8/3/22  
Valid up to: 7/3/22

10/11  
Tower-4  
L9, U9, T9 & Roof Plan

JISHNU PAL  
GEO-TECHNICAL ENGINEER  
Enrollment No: GTER/NKDA/10/00093

Sanjiv Parekh  
CIVIL STRUCTURAL ENGINEER  
Enrollment No: BTER/NKDA/10/00030

Subir Ranjan Sarker  
TOWN PLANNER/URBAN DESIGNER  
Enrollment No: TPER/NKDA/10/00036